

ULC SYSTEM No. JF100

F, FH, FT and FTH Ratings – 2 h

Nominal Joint Width – 89 mm
Movement Capabilities – 14.3% Compression or Extension

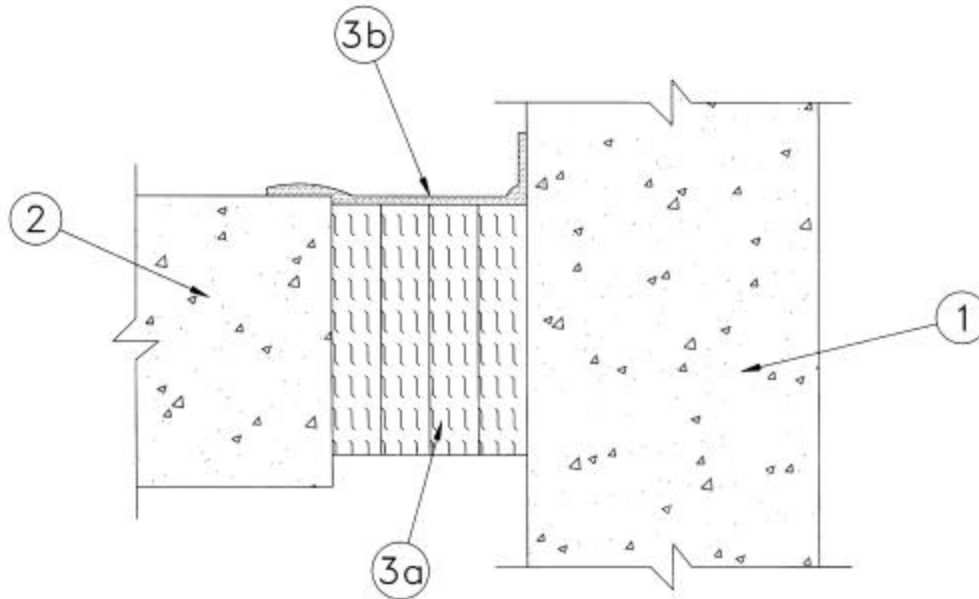

1. **Wall Assembly** - Minimum 115 mm thick steel-reinforced low-density or normal-density (1600 to 2400 kg/m^3) structural concrete. Wall may also be constructed of nominal 200 mm thick concrete block.

2. **Floor Assembly** - Minimum 115 mm thick steel-reinforced low-density or normal-density (1600 to 2400 kg/m^3) structural concrete.

3. **Joint System** - Maximum separation between edge of floor and face of wall (at time of installation of joint system) is 89 mm. The joint system is designed to accommodate a maximum 14.3% compression or extension from its installed width. The joint system shall consist of the following:

- **(a) Firestop System Components** - (Guide No. 40 U19.13). Minimum 102 mm thickness of minimum 64 kg/m^3 "A/D FIREBARRIER Mineral Wool" batt insulation installed in joint opening as a permanent form. Pieces of batt cut into strips and installed edge-first into joint opening, parallel with joint direction, such that batt sections are compressed minimum 30% in thickness and that the compressed batt sections are flush with top surface of floor. Adjoining lengths of batt to be tightly-butted with butted seams spaced minimum 610 mm. apart along the length of the joint.

A/D FIRE PROTECTION SYSTEMS INC.

- **(b) Firestop System Components** - (Guide No. 40 U19.13). Minimum 3.2 mm wet thickness of "A/D FIREBARRIER Seal N/S" sprayed or brushed on the top surface of floor to completely cover mineral wool and overlapping a minimum 13mm onto concrete.

A/D FIRE PROTECTION SYSTEMS INC.

July 25, 2002